

MUNICIPALITY OF THE

JUR: 47

COUNTY OF

AAN: 03849805

CUMBERLAND

Primary Assignment:

47 -

Secondary Assignment: -

**NBHD: 470353 LUC: 0111 Res/Com: R ROLLTYPE: RPROLLEYEAR: 2027**

**PYE FLORENCE L**

**9613 HIGHWAY 6 PUGWASH**

1 of 11

Land Size 20,000.00 Sq. Ft.

## Values History

Year	Land	Building	OBY	Total Building	Total Market Value Assessment	Cap Assessment
2026	\$8,300	\$0	7000	\$7,000	\$15,300	\$15,200
2025	\$8,300	\$0	7000	\$7,000	\$15,300	\$14,900
2024	\$8,300	\$0	7000	\$7,000	\$15,300	\$14,700
2023	\$8,300	\$0	7000	\$7,000	\$15,300	\$14,300
2022	\$6,300	\$0	7000	\$7,000	\$13,300	\$0
2021	\$6,300	\$0	7000	\$7,000	\$13,300	\$0
2020	\$6,300	\$0	7000	\$7,000	\$13,300	\$0
2019	\$6,300	\$22,700	2700	\$25,400	\$31,700	\$0
2018	\$6,300	\$22,300	2700	\$25,000	\$31,300	\$0
2017	\$6,300	\$24,000	2700	\$26,700	\$33,000	\$32,500
2016	\$6,300	\$23,000	2800	\$25,800	\$32,100	\$0
2015	\$6,300	\$0	33900	\$33,900	\$40,200	\$34,100
2014	\$6,300	\$0	31300	\$31,300	\$37,600	\$33,400
2013	\$6,200	\$0	29100	\$29,100	\$35,300	\$33,200
2012	\$6,200	\$0	0	\$0	\$6,200	\$4,100
2011	\$6,200	\$0	0	\$0	\$6,200	\$4,000
2010	\$6,200	\$0	0	\$0	\$6,200	\$3,900
2009	\$5,600	\$0	0	\$0	\$5,600	\$3,900
2008	\$5,000	\$0	0	\$0	\$5,000	\$3,900

## MH Data

MH Width:

MH Length:

MH Make:

MH Model:

MH Park Name:

MH Serial #:

**AAN 03849805 - 9613 Hwy 6, Pugwash "A graphical representation only"**



04/28/2023

# 03849805 9613 HIGHWAY 6, PUGWASH A GRAPHICAL REPRESENTATION ONLY

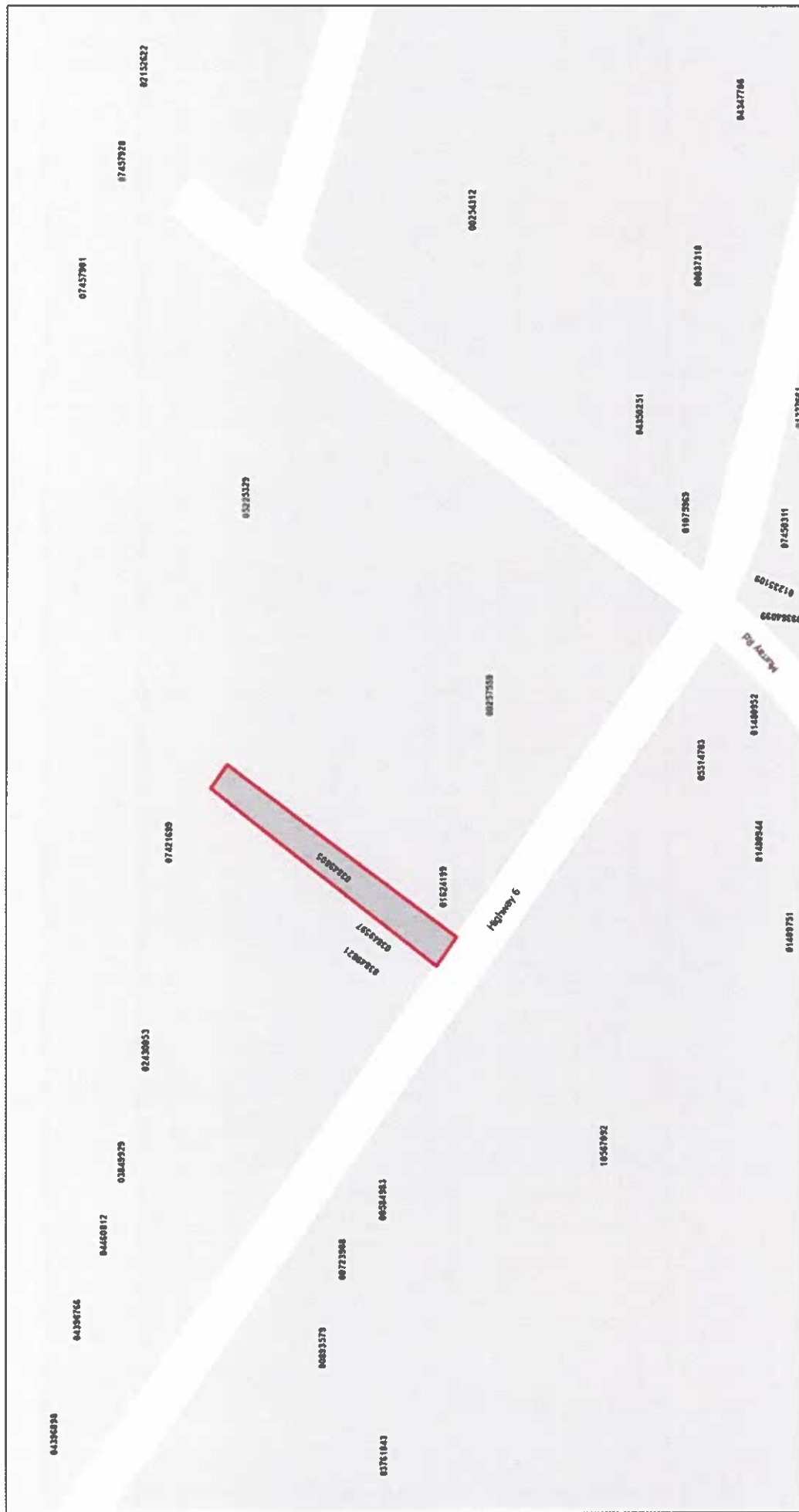

January 21, 2026

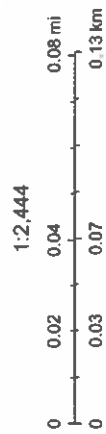

TAX ACCOUNT#: 03849805  
PROPERTY: 9613 Highway 6, Pugwash, Nova Scotia  
ASSESSED TO: Kelly Pye  
APPARENT PID: 25147562

---

ALL that certain piece, parcel or lot of land situate, lying and being on the West side of Pugwash Harbour, on the Northeast side of the Main Road, leading from Pugwash to Port Philip, in the County of Cumberland, Province of Nova Scotia, and more fully bounded and described as follows:

BEGINNING at the Northwest corner of a lot of land formerly owned and occupied by H. Petersen;

THENCE Northwesterly along said Petersen line a distance of Four Hundred feet (400') or a sufficient distance to make over a half acre (  $\frac{1}{2}$  ), when Deed is completed;

THENCE Westerly parallel with the Main Road a distance of Fifty feet (50') to a stake;

THENCE Southerly parallel with and at a distance from the first line by Fifty feet (50') to the Main Road;

THENCE Easterly along the Main Road a distance of Fifty feet (50') to place of beginning;

CONTAINING One-half acre (  $\frac{1}{2}$  );

BEING the same lot of land as conveyed by Deed by Joseph Pye to James Erving Pye and registered in the Registry of Deeds at Amherst, N.S., in Book 264, at Page 773.

AND BEING that lot of land conveyed to Charles Edward Pye and Florence Louise Pye by Deed dated the 25th day of May, A.D., 1981